

NOTE:
PATCHING DONE BY NCDOT FORCES

ROWAN COUNTY
NORTH CAROLINA

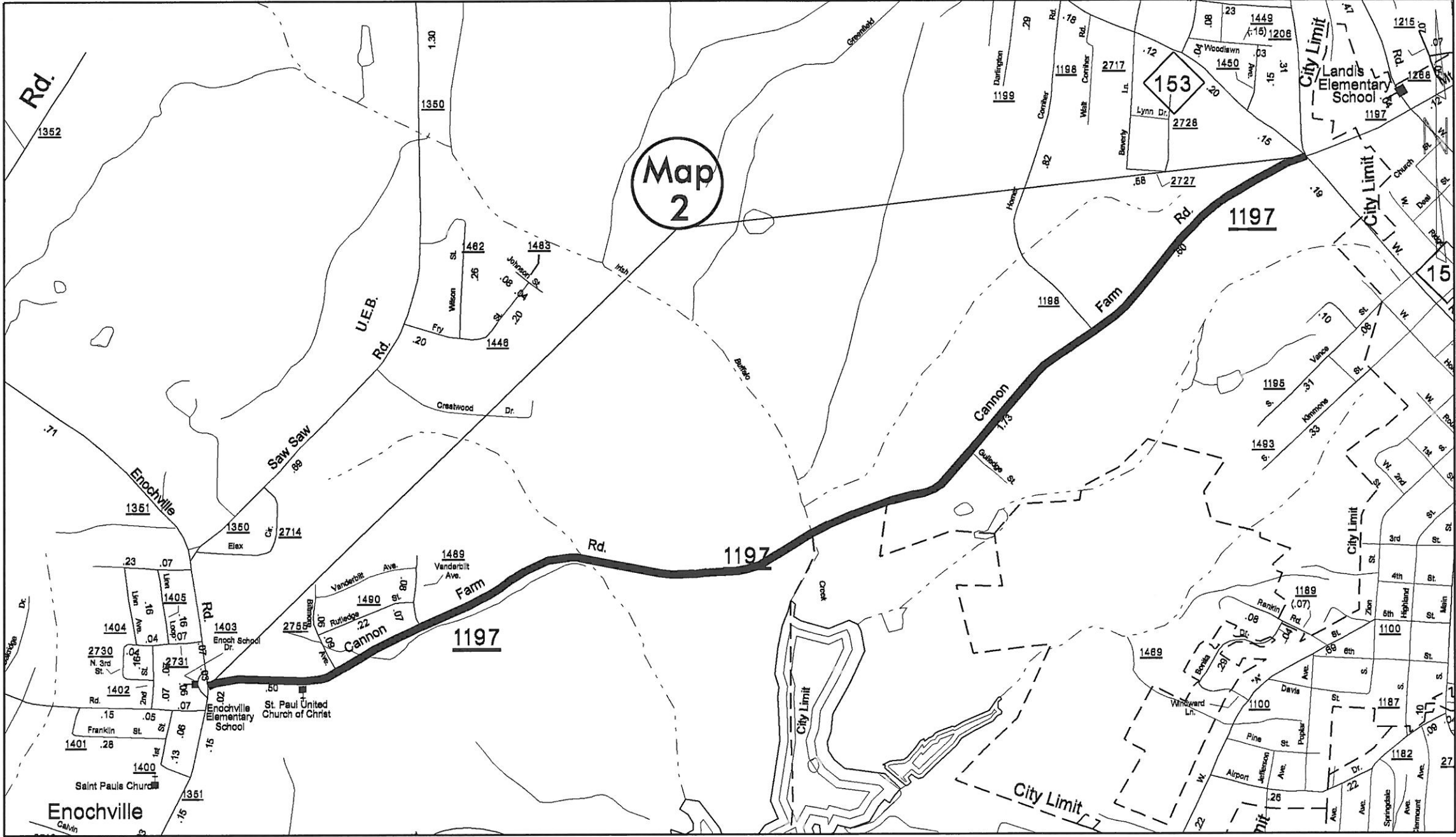

NOTE:
PATCHING DONE BY
NCDOT FORCES

ROWAN COUNTY
NORTH CAROLINA

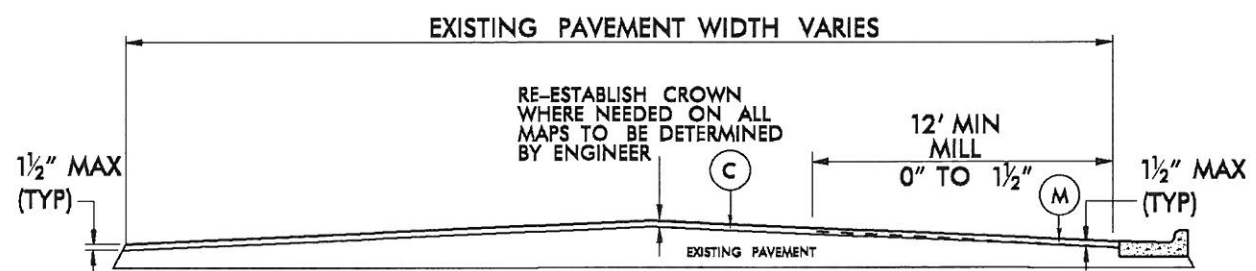

TYPICAL SECTION NO. 1
MAP NO. 1 OLD CONCORD ROAD (SR 1002)
 NOTE: ALL CURB AND GUTTER IS EXISTING

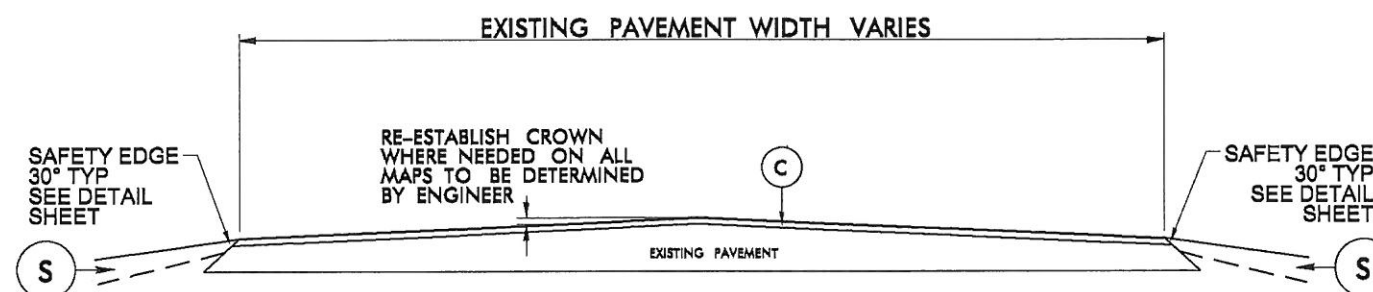

Shoulder reconstruction in areas only with no outside curb (typ.)

TYPICAL SECTION NO. 2
MAP NO. 1 OLD CONCORD ROAD (SR 1002)
MAP NO. 2 CANNON FARM ROAD (SR 1197)

Shoulder reconstruction in areas only with no outside curb (typ.)

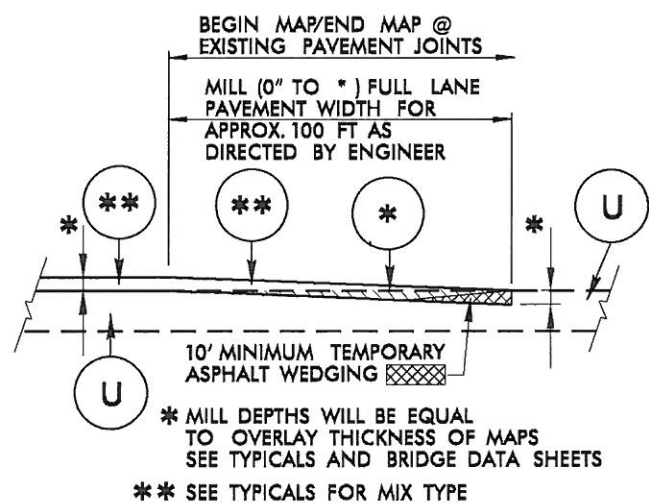

INCIDENTAL TIE-IN MILLING DETAIL

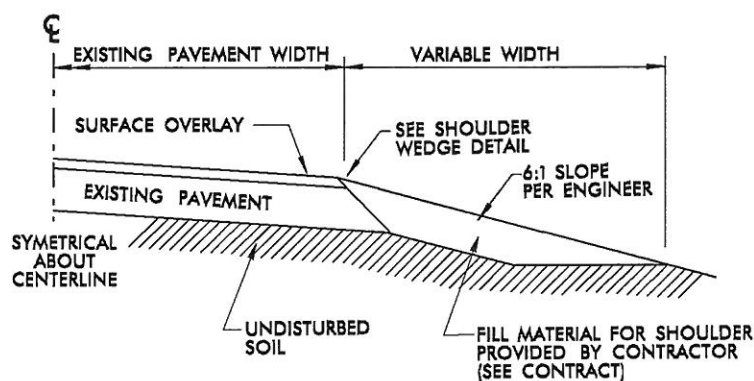

SHOULDER RECONSTRUCTION

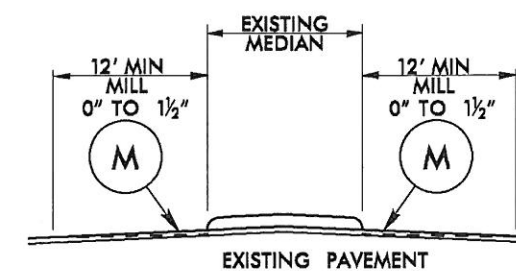

MILLING AT MEDIANS

PAVEMENT SCHEDULE	
C	PROP. APPROX. 1 1/2" ASPHALT CONCRETE SURFACE COURSE, TYPE S9.5B, TO BE APPLIED AT AN AVERAGE RATE OF 168 LBS PER SQ YD
M	MILL ASPHALT PAVEMENT, 0 TO 1 1/2" DEPTH
S	SHOULDER RECONSTRUCTION (SEE DETAIL)
U	EXISTING PAVEMENT

NOTES: Less than 5' - 10' undisturbed buffer from ROW, ditchline, water feature, or drainage inlet, add BMP.

BMP Options: Wattle or Silt Fence

EROSION CONTROL DETAIL

PROJECT REFERENCE NO.	SHEET NO.
9CR.20801.131	4

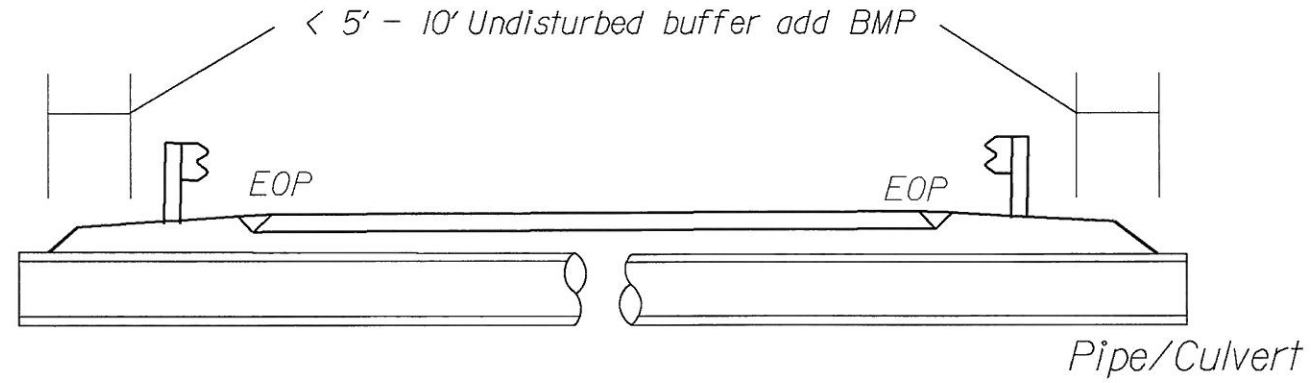

< 5' - 10' Undisturbed buffer from jurisdictional feature add BMP

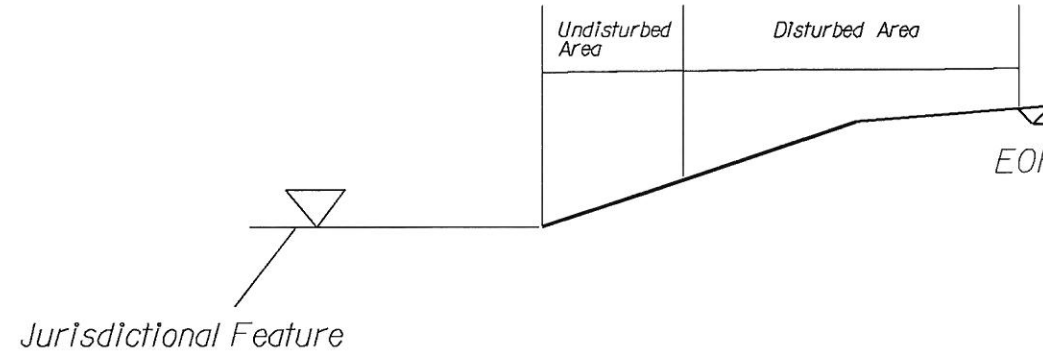

< 5' - 10' Undisturbed buffer from ditchline, add BMP

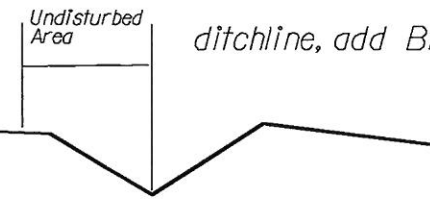

Use BMP's if shoulders and/or frontslopes and/or ditchline and/or backslopes are disturbed

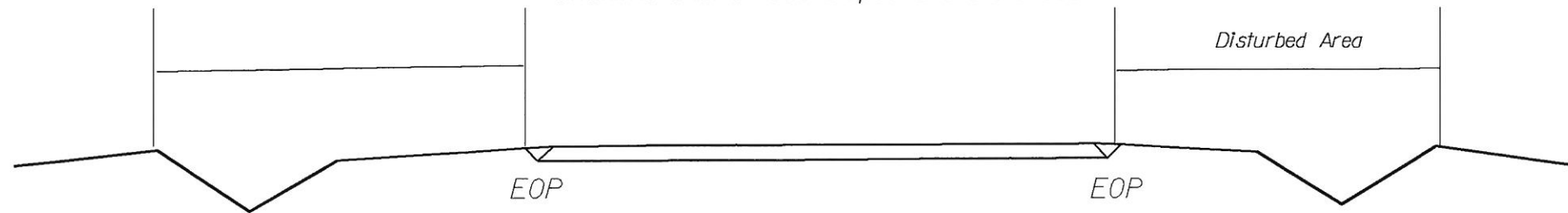

< 5' - 10' Undisturbed buffer from inlet, add wattle

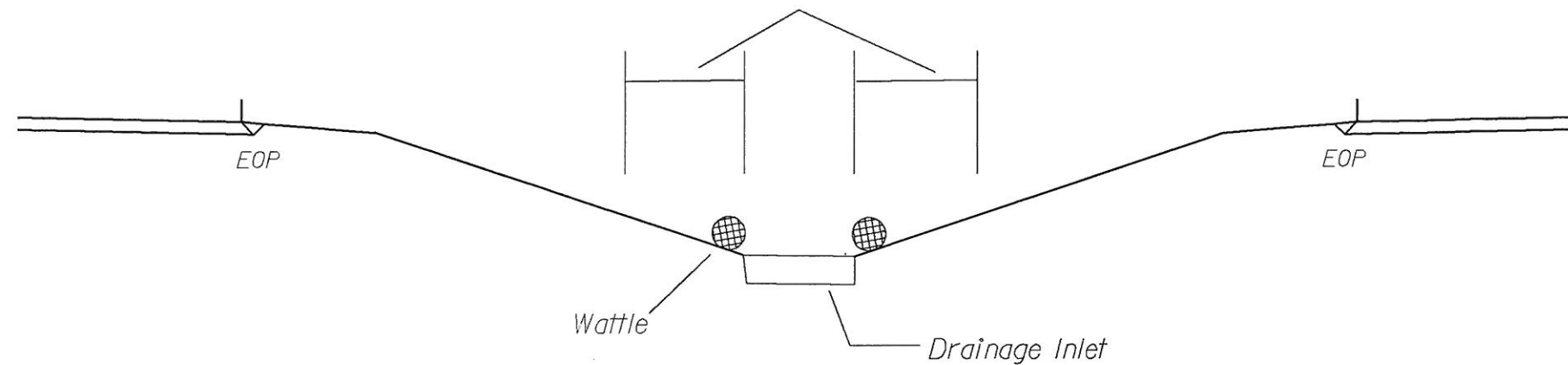

NOT TO SCALE

PROJECT REFERENCE NO.	SHEET NO.
RW SHEET NO.	
ROADWAY DESIGN ENGINEER	HYDRAULICS ENGINEER

WATTLE DETAIL

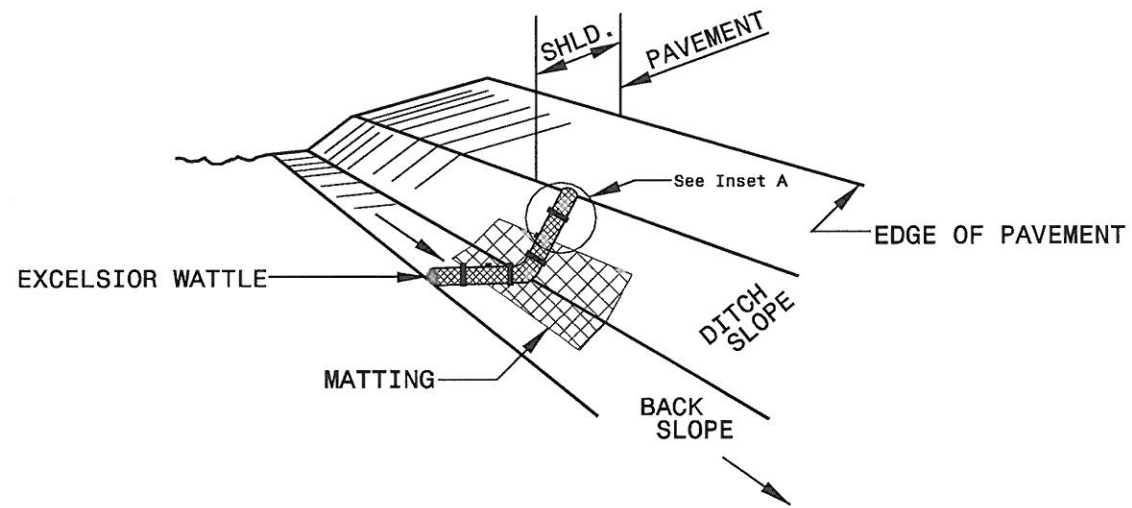

ISOMETRIC VIEW

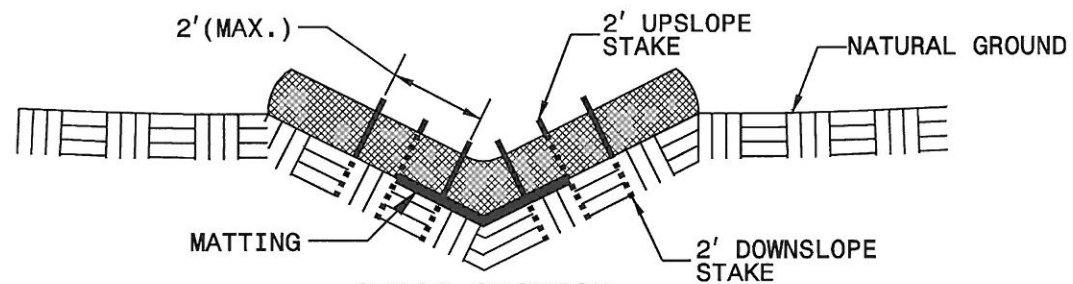

CROSS SECTION VEE DITCH

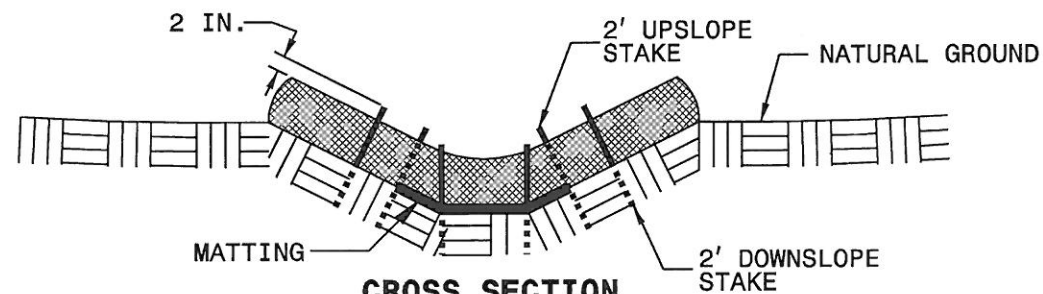

CROSS SECTION TRAPEZOIDAL DITCH

NOTES:

USE MINIMUM 12 IN. DIAMETER EXCELSIOR WATTLE.

USE 2 FT. WOODEN STAKES WITH A 2 IN. BY 2 IN. NOMINAL CROSS SECTION.

ONLY INSTALL WATTLE(S) TO A HEIGHT IN DITCH SO FLOW WILL NOT WASH AROUND WATTLE AND SCOUR DITCH SLOPES AND AS DIRECTED.

INSTALL A MINIMUM OF 2 UPSLOPE STAKES AND 4 DOWNSLOPE STAKES AT AN ANGLE TO WEDGE WATTLE TO BOTTOM OF DITCH.

PROVIDE STAPLES MADE OF 0.125 IN. DIAMETER STEEL WIRE FORMED INTO A U SHAPE NOT LESS THAN 12" IN LENGTH.

INSTALL STAPLES APPROXIMATELY EVERY 1 LINEAR FOOT ON BOTH SIDES OF WATTLE AND AT EACH END TO SECURE IT TO THE SOIL.

INSTALL MATTING IN ACCORDANCE WITH SECTION 1631 OF THE STANDARD SPECIFICATIONS.

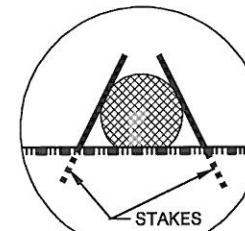

INSET A

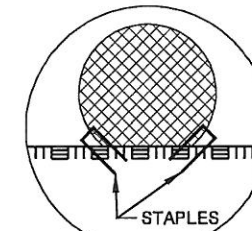

INSET B

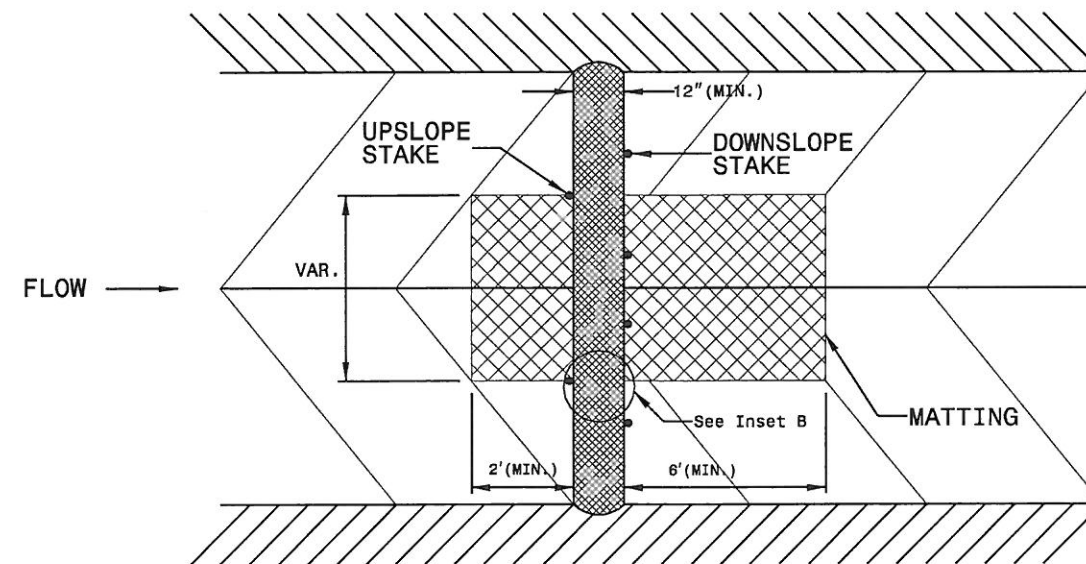

TOP VIEW

PROJECT NO.	SHEET NO.	TOTAL NO.
9CR.20801.131	7	

SUMMARY OF QUANTITIES

PROJECT NO	COUNTY	MAP NO	ROUTE	DESCRIPTION	TYP	FINAL SURFACE TESTING REQUIRED	WARM MIX ASPHALT REQUIRED	LENGTH MI	WIDTH FT	BORROW EXCAVATION CY	INCIDENTAL STONE BASE TONS	SHOULDER RECONSTRUCTION SMI	MILLING ASPHALT PAVEMENT, 0" TO 1 1/2" DEPTH SY	INCIDENTAL MILLING SY	SURFACE COURSE, S9.5B TONS	ASPHALT BINDER FOR PLANT MIX TONS	TEMPORARY SILT FENCE LF	WATTLE LF
9CR.20801.131	Rowan	1	SR 1002 OLD CONCORD ROAD	FROM PAVEMENT JOINT AT CABARRUS COUNTY LINE TO PAVEMENT JOINT AT NC 152	1	NO	NO	4.396	24	528	255	8.79	333	489	5,749	345	1,758	176
TOTAL FOR MAP NO. 1								4.396		528	255	8.79	333	489	5,749	345	1,758	176
9CR.20801.131	Rowan	2	SR 1194 CANNON FARM ROAD	FROM NC 153 TO ENOCHVILLE AVENUE	1	NO	NO	2.828	22	339	192	5.66		489	3,698	222	1,131	113
TOTAL FOR MAP NO. 2								2.828		339	192	5.66		489	3,698	222	1,131	113
TOTAL FOR PROJ NO. 9CR.20801.131								7.224		867	447	14.45	333	978	9,447	567	2,889	289
GRAND TOTAL								7.224		867	447	14.45	333	978	9,447	567	2,889	289

PROJECT NO.	SHEET NO.	TOTAL NO.
9CR.20801.131	8	

THERMOPLASTIC AND PAINT QUANTITIES

PROJECT NO	COUNTY	MAP NO	ROUTE	DESCRIPTION	LENGTH	WIDTH	4685000000-E	4686000000-E		4710000000-E	4721000000-E			4835000000-E	4840000000-N		
							4" X 90 M WHITE THERMO LF	4" X 120 M YELLOW THERMO LF	4" X 120 M WHITE THERMO LF	24" X 120 M WHITE THERMO LF	THERMO MSG STOP 120 M EA	THERMO MSG AHEAD 120 M EA	THERMO MSG SCHOOL 120 M EA	24" WHITE PAINT LF	PAINT MSG AHEAD EA	PAINT MSG STOP EA	PAINT MSG SCHOOL EA
9CR.20801.131	Rowan	1	SR 1002 OLD CONCORD ROAD	FROM PAVEMENT JOINT AT CABARRUS COUNTY LINE TO PAVEMENT JOINT AT NC 152	4.396	24	47,301	46,422	580		8	10			10	8	
TOTAL FOR MAP NO. 1					4.396		47,301	46,422	580		8	10			10	8	
9CR.20801.131	Rowan	2	SR 1194 CANNON FARM ROAD	FROM NC 153 TO ENOCHVILLE AVENUE	2.828	22	30,429	29,864		50			6	50			6
TOTAL FOR MAP NO. 2					2.828		30,429	29,864		50			6	50			6
TOTAL FOR PROJ NO. 9CR.20801.131					7.224		77,730	76,286	580	50	8	10	6	50	10	8	6
GRAND TOTAL					7.224		77,730	76,286	580	50	8	10	6	50	10	8	6
								76,866				24			24		